

967200 GHC 12/50 S

967000 GHC 16/50 S

967300 GHD 3.0/75 S

967100 GHD 4.5/75 S

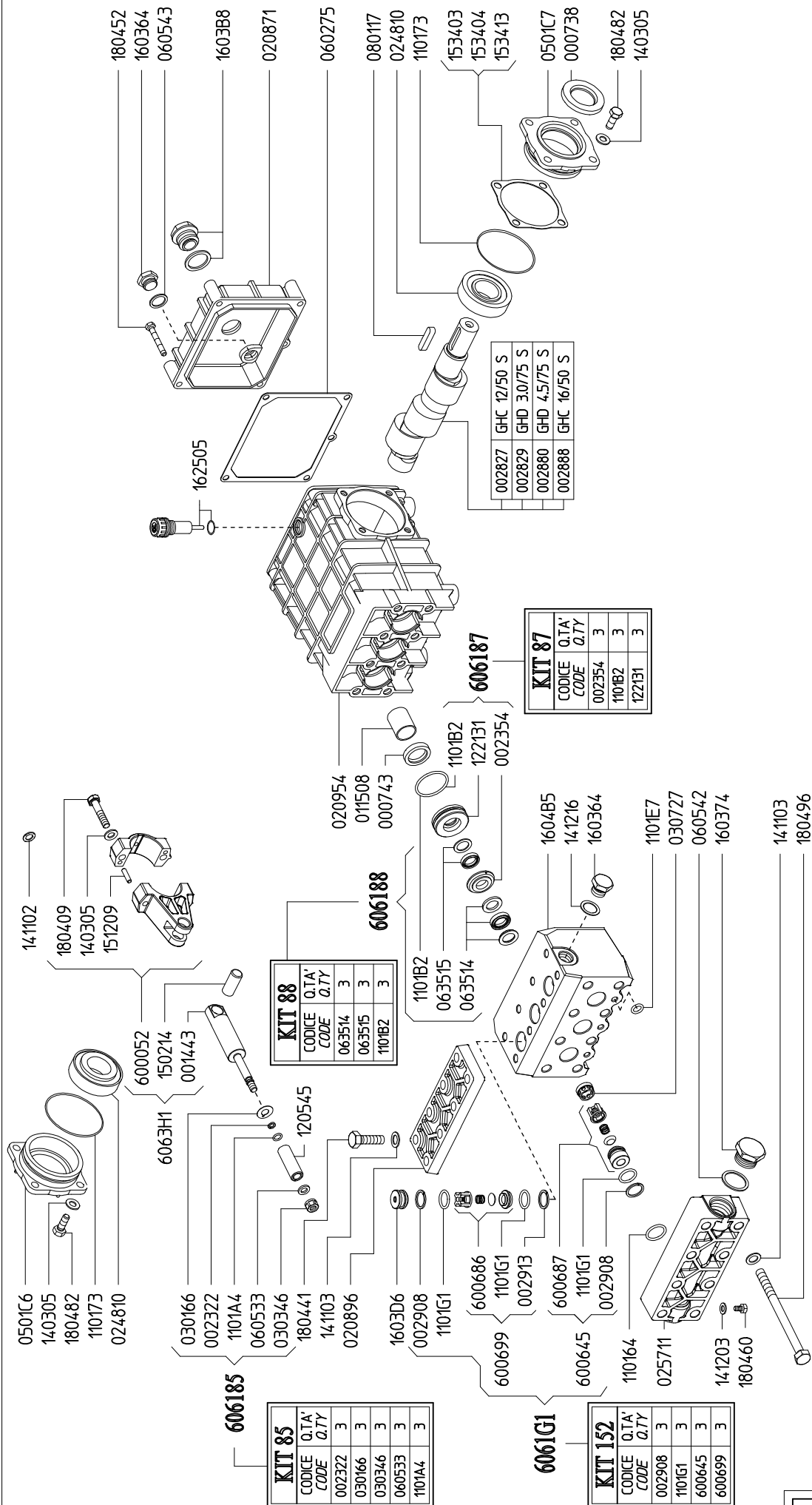

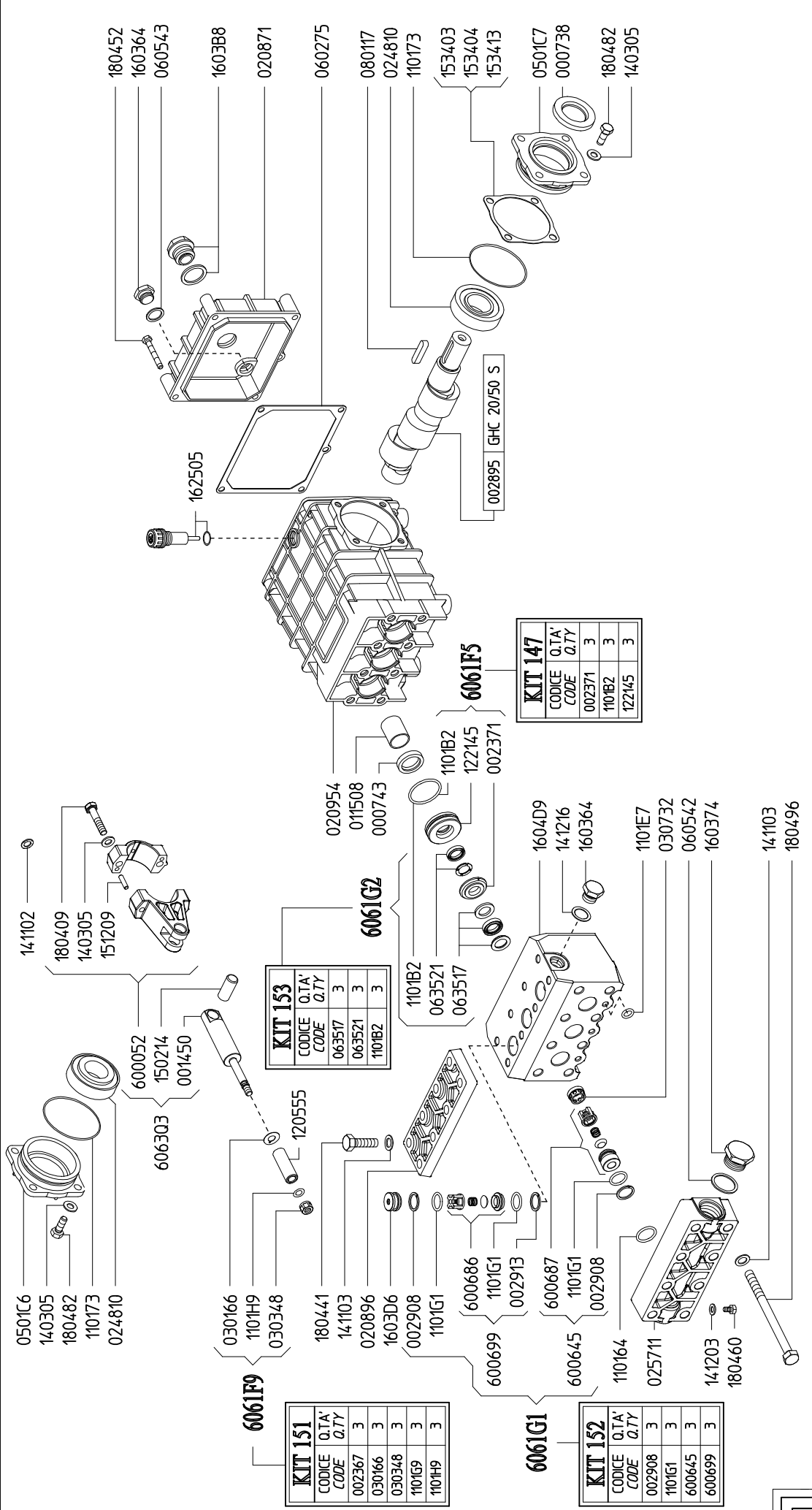

KIT 151

CODICE CODE	Q.TA. Q.TY
002367	3
030166	3
030348	3
1101G9	3
1101H9	3

KIT 152

CODICE CODE	Q.TA. Q.TY
002908	3
1101G1	3
600645	3
600699	3

KIT 153

CODICE CODE	Q.TA. Q.TY
063517	3
063521	3
1101B2	3

KIT 147

CODICE CODE	Q.TA. Q.TY
002371	3
1101B2	3
122145	3

SERIE - SERIES

HWT

270300 PKWTC 11/15 S

270200 PKWTC 13/15 S

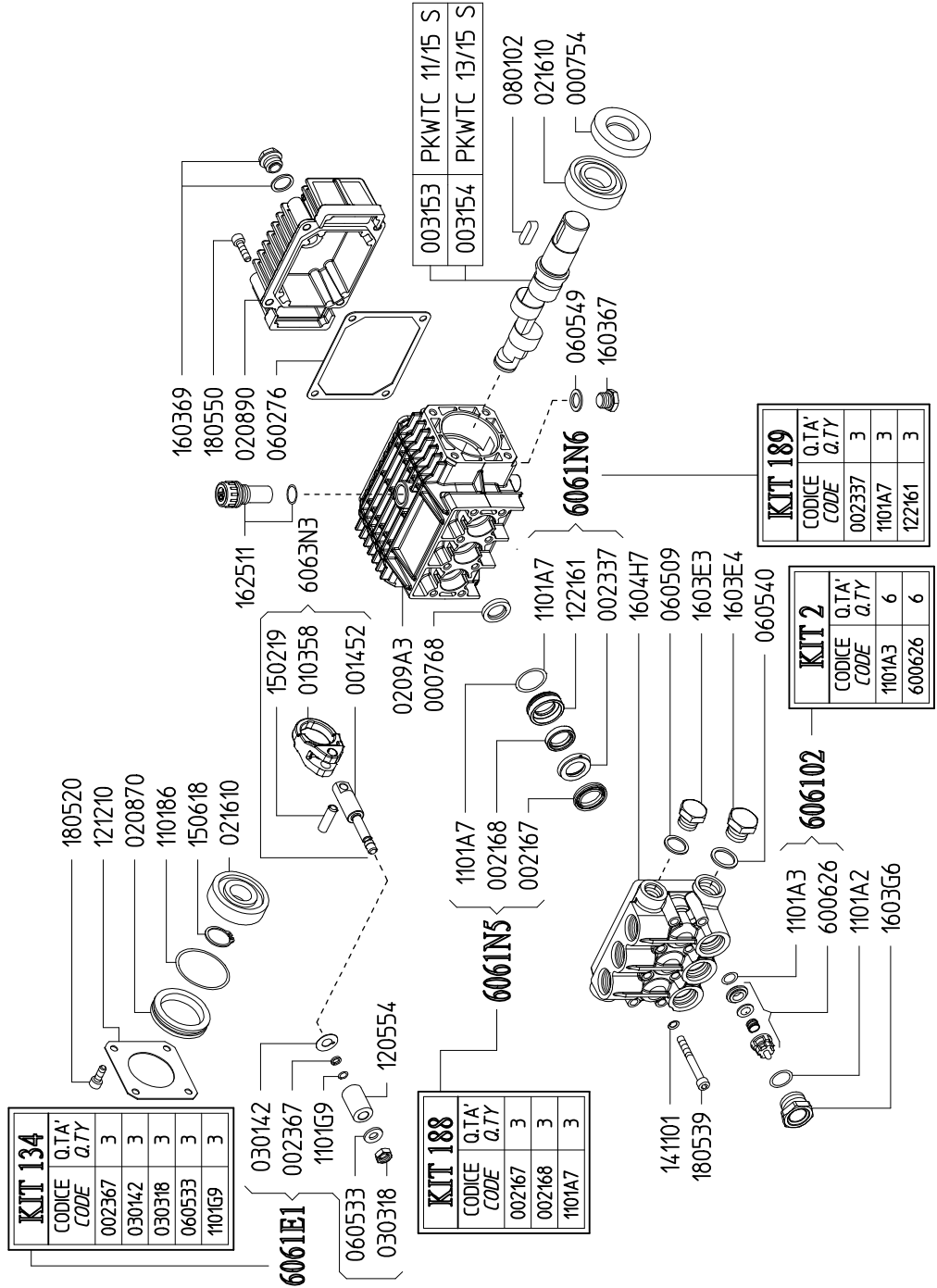

SERIE - SERIES

HWT

927100 MWTC 16/15 S

927000 MWTC 20/15 S

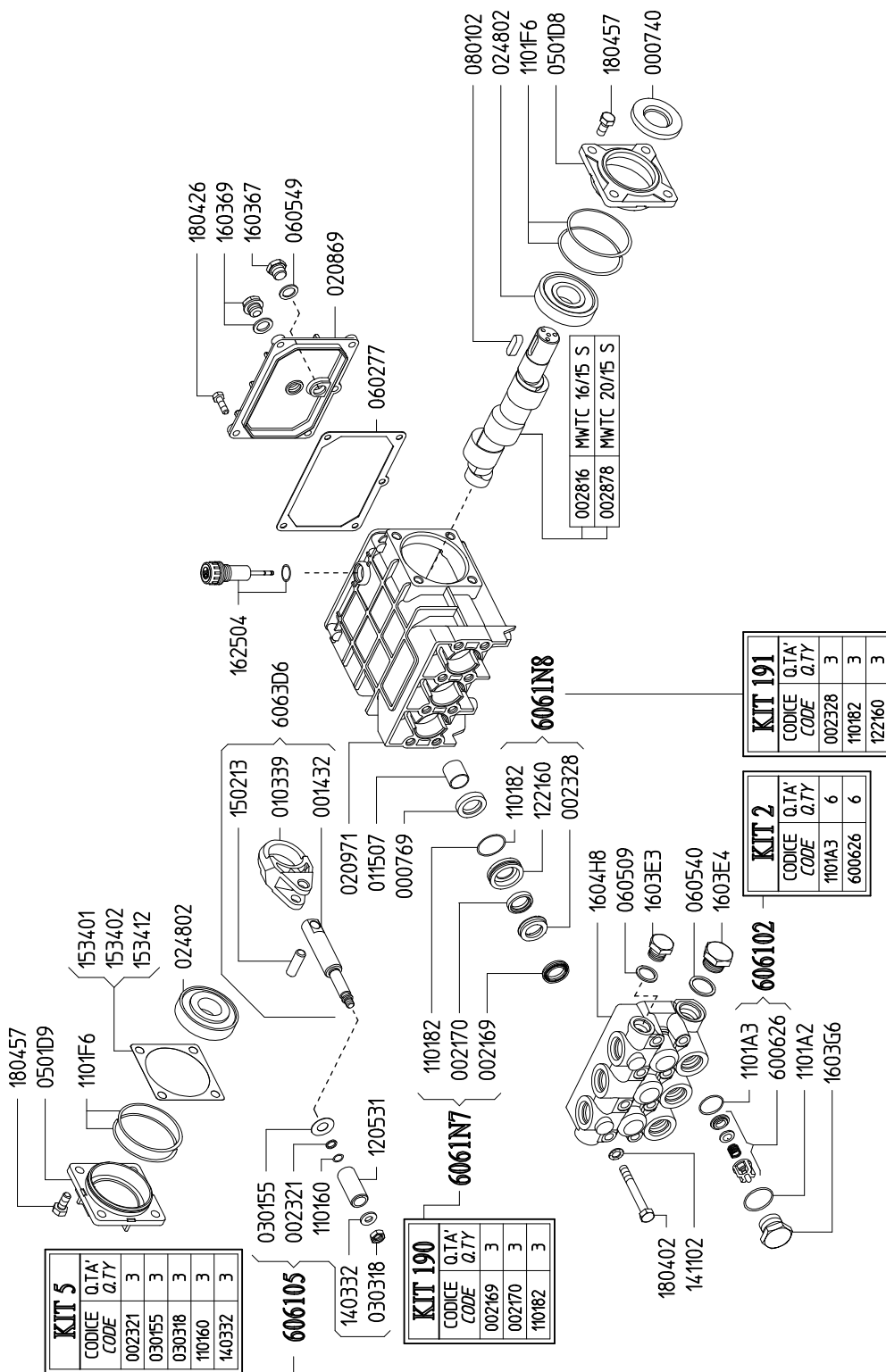

SERIE - SERIES

HWT

890000 GWTC 26/20 S

925000 GWTC 34/20 S

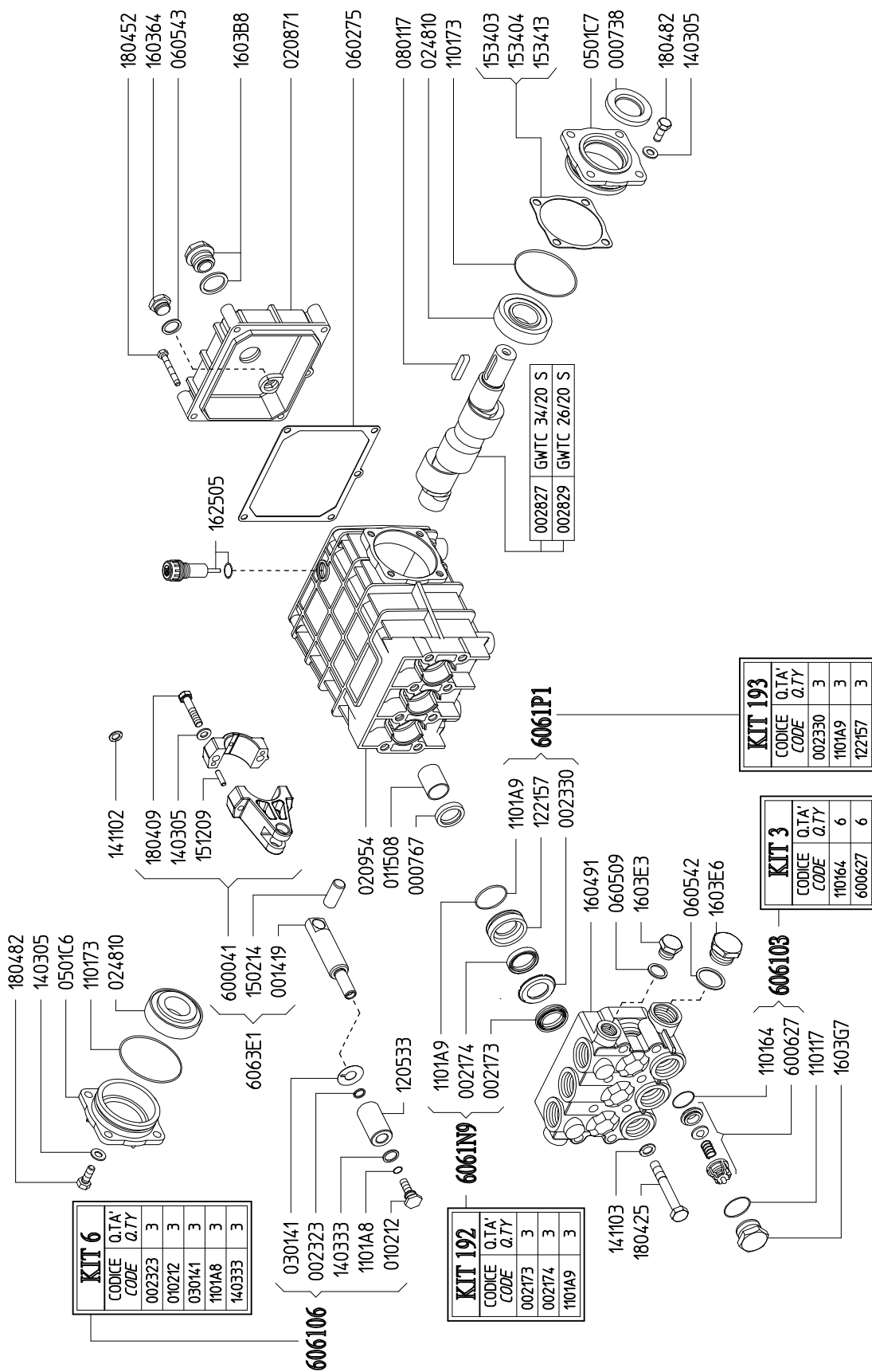

890100 GWTC 42/15 S

890200 GWTC 50/15 S

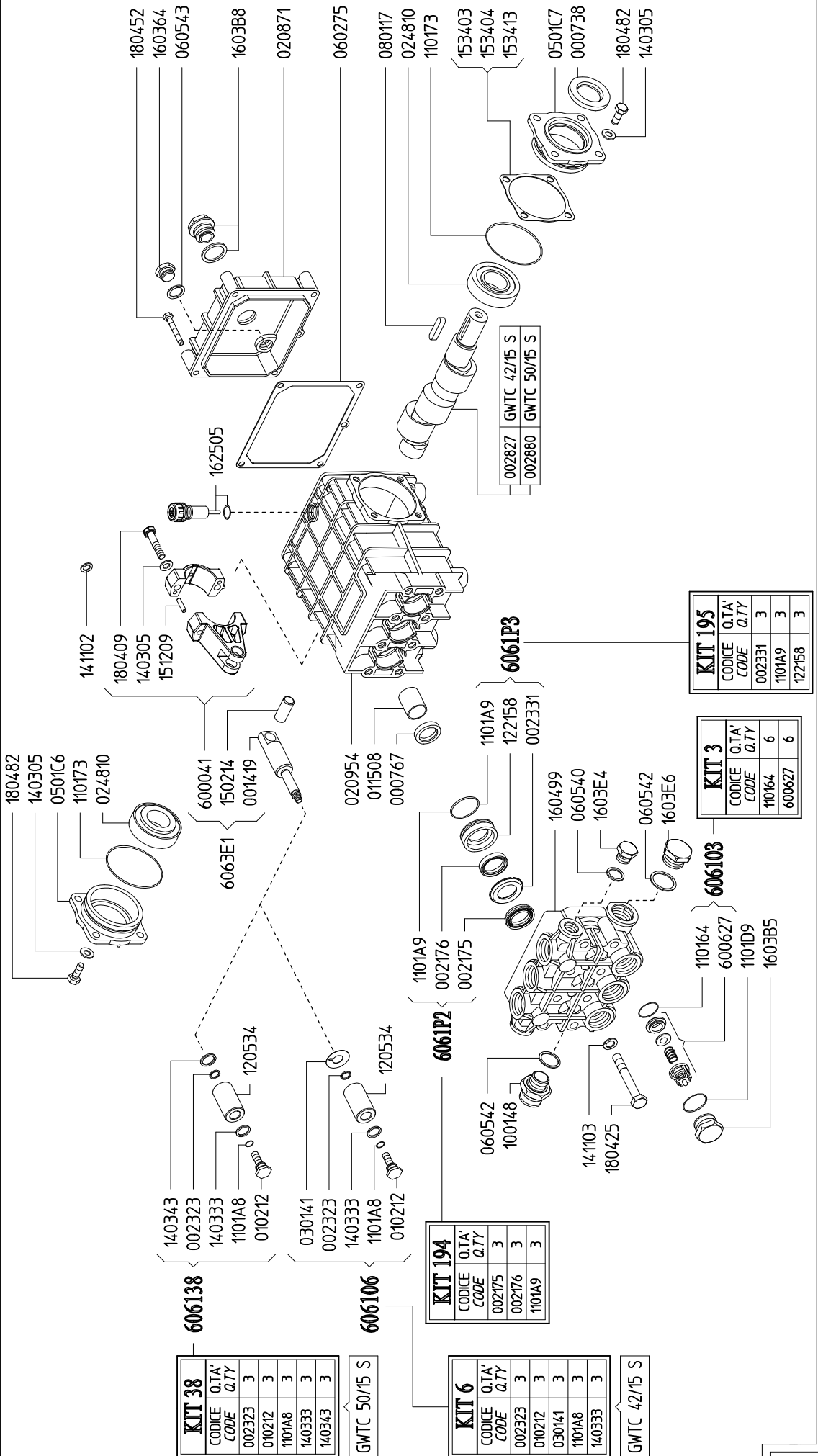

KIT 38

CODICE CODE	Q.TA. Q.TY
002323	3
010212	3
1101A8	3
140333	3
140343	3

GWTC 50/15 S

KIT 6

CODICE CODE	Q.TA. Q.TY
002323	3
010212	3
030141	3
1101A8	3
140333	3

GWTC 42/15 S

KIT 194

CODICE CODE	Q.TA. Q.TY
002175	3
002176	3
1101A9	3

KIT 3

CODICE CODE	Q.TA. Q.TY
110164	6
600627	6

KIT 195

CODICE CODE	Q.TA. Q.TY
002331	3
1101A9	3
122158	3

SERIE - SERIES
INOX
STAINLESS STEEL

915800 PSC 11/15 S

915900 PSC 13/15 S

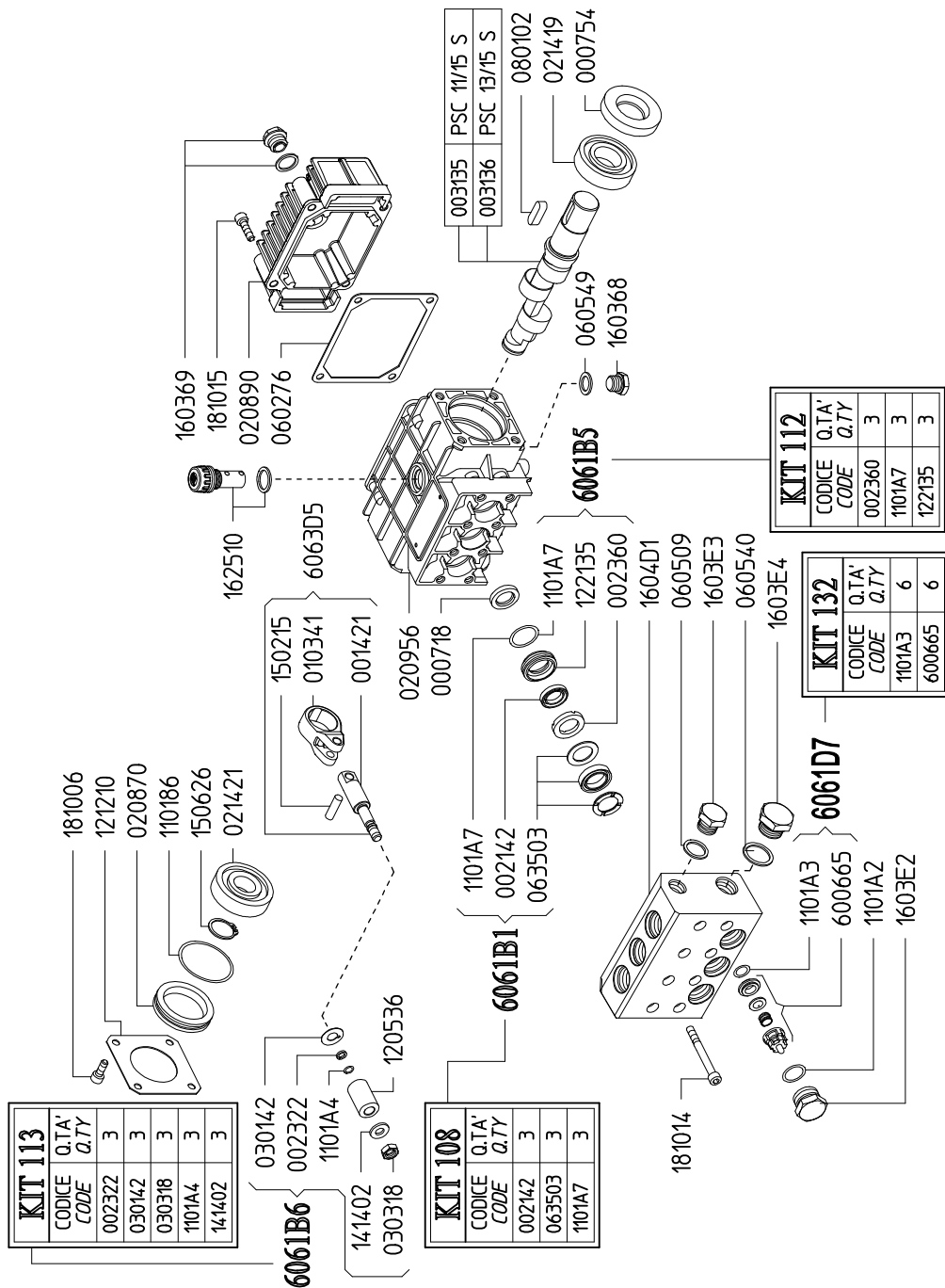

SERIE - SERIES
INOX
STAINLESS STEEL

931800 MSC 16/20 S

931700 MSC 20/20 S

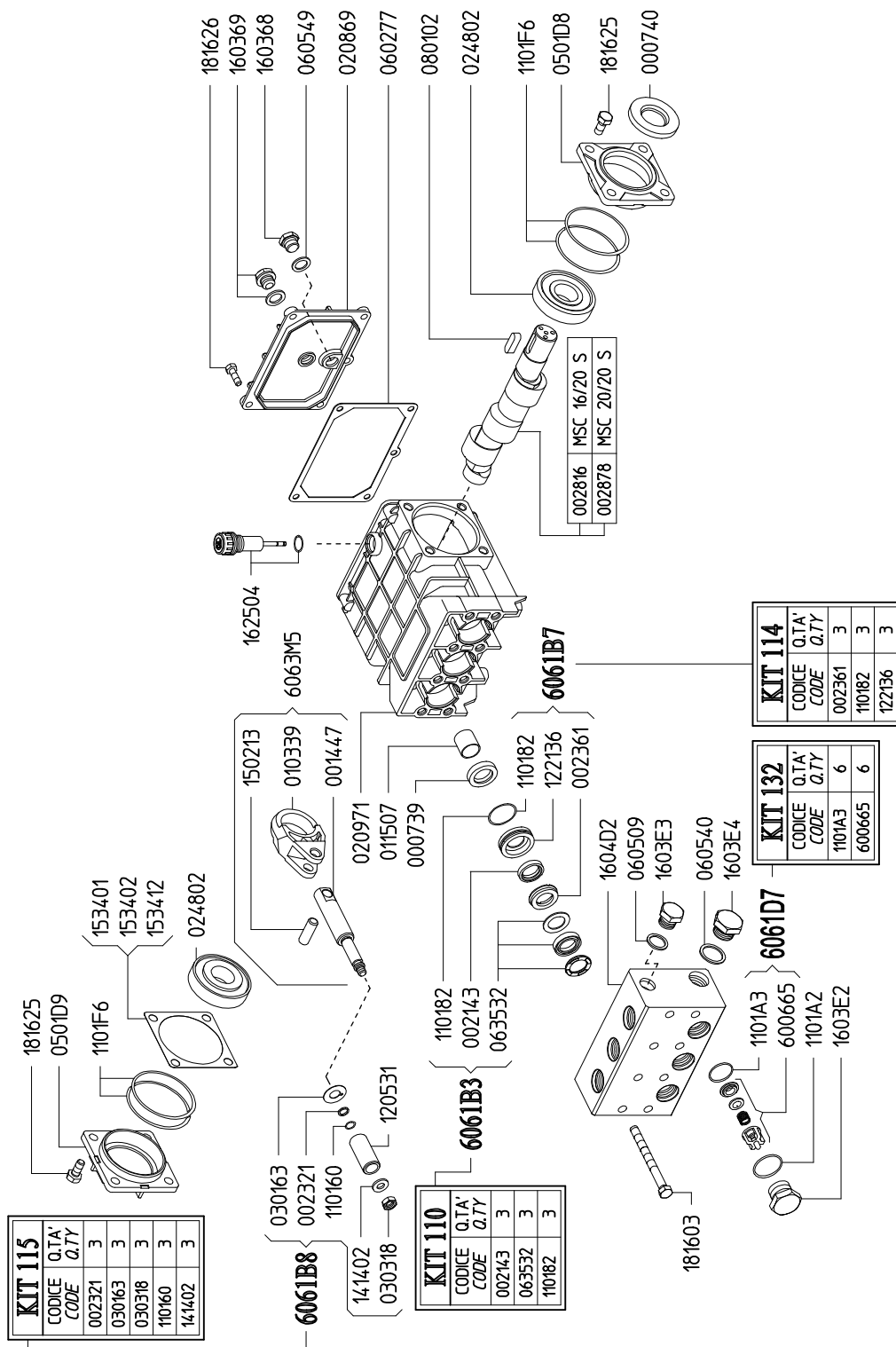

SERIE - SERIES
INOX
STAINLESS STEEL

- 969600 GSC 27/20 S
- 969700 GSC 34/20 S
- 969800 GSC 42/15 S
- 923400 GSC 50/15 S

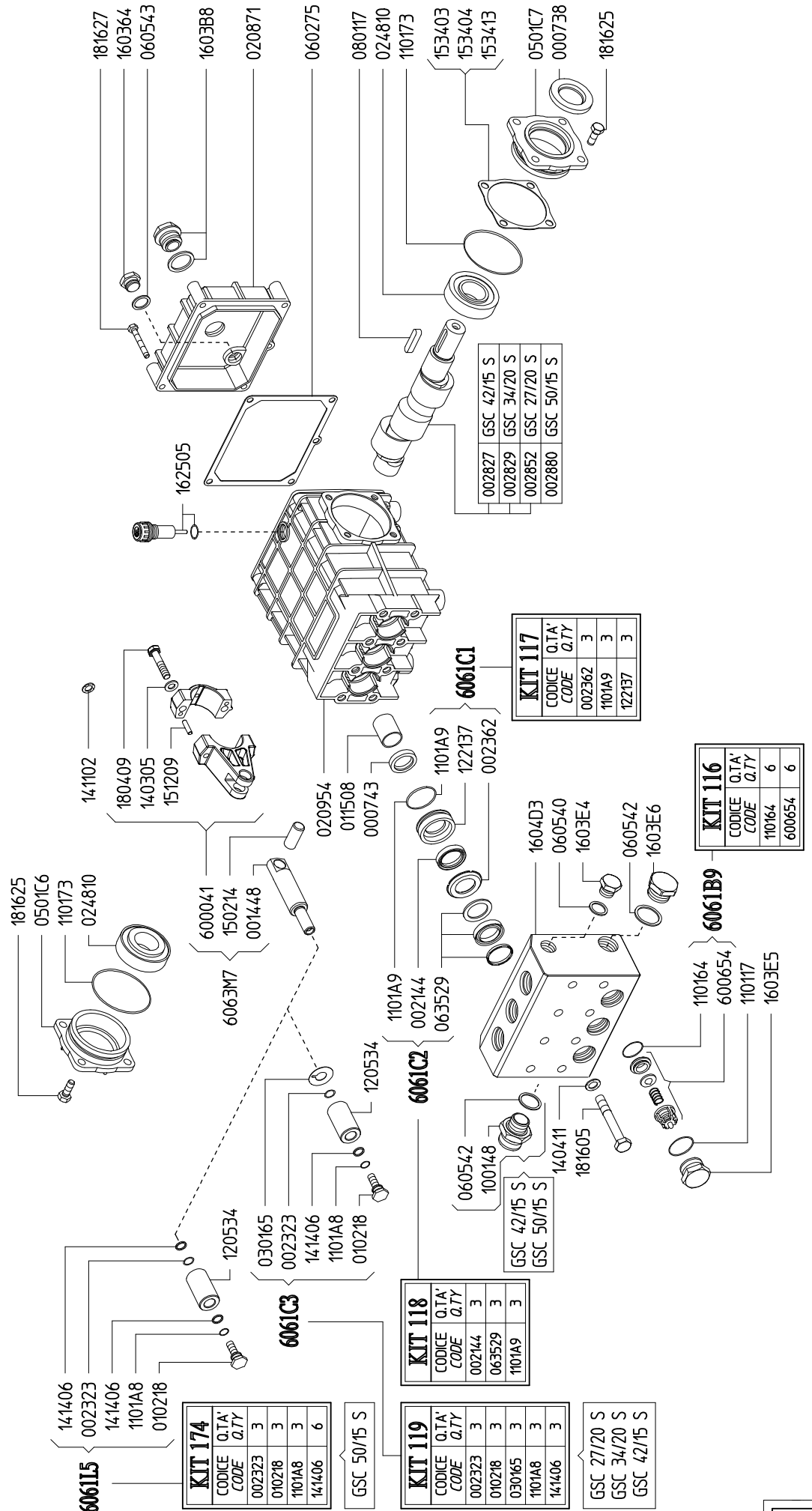

SERIE - SERIES

NX

849000 NX-B 25/300 R

849100 NX-B 25/300 L

845600 NX-C 35/300 R

845900 NX-C 35/300 L

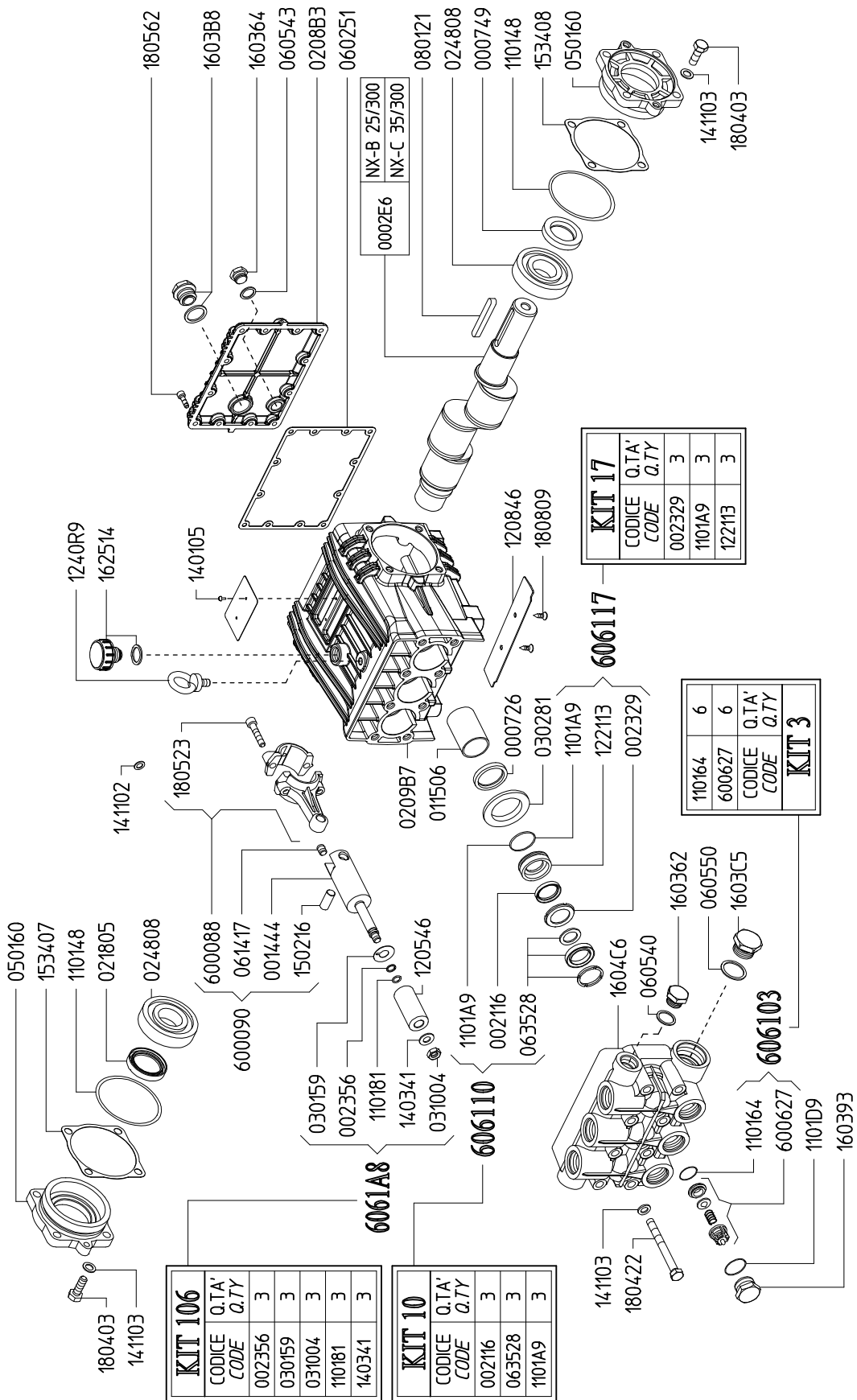

SERIE - SERIES

NX

814900 NX-B 30/280 R

815000 NX-B 30/280 L

838800 NX-C 44/280 R

838900 NX-C 44/280 L

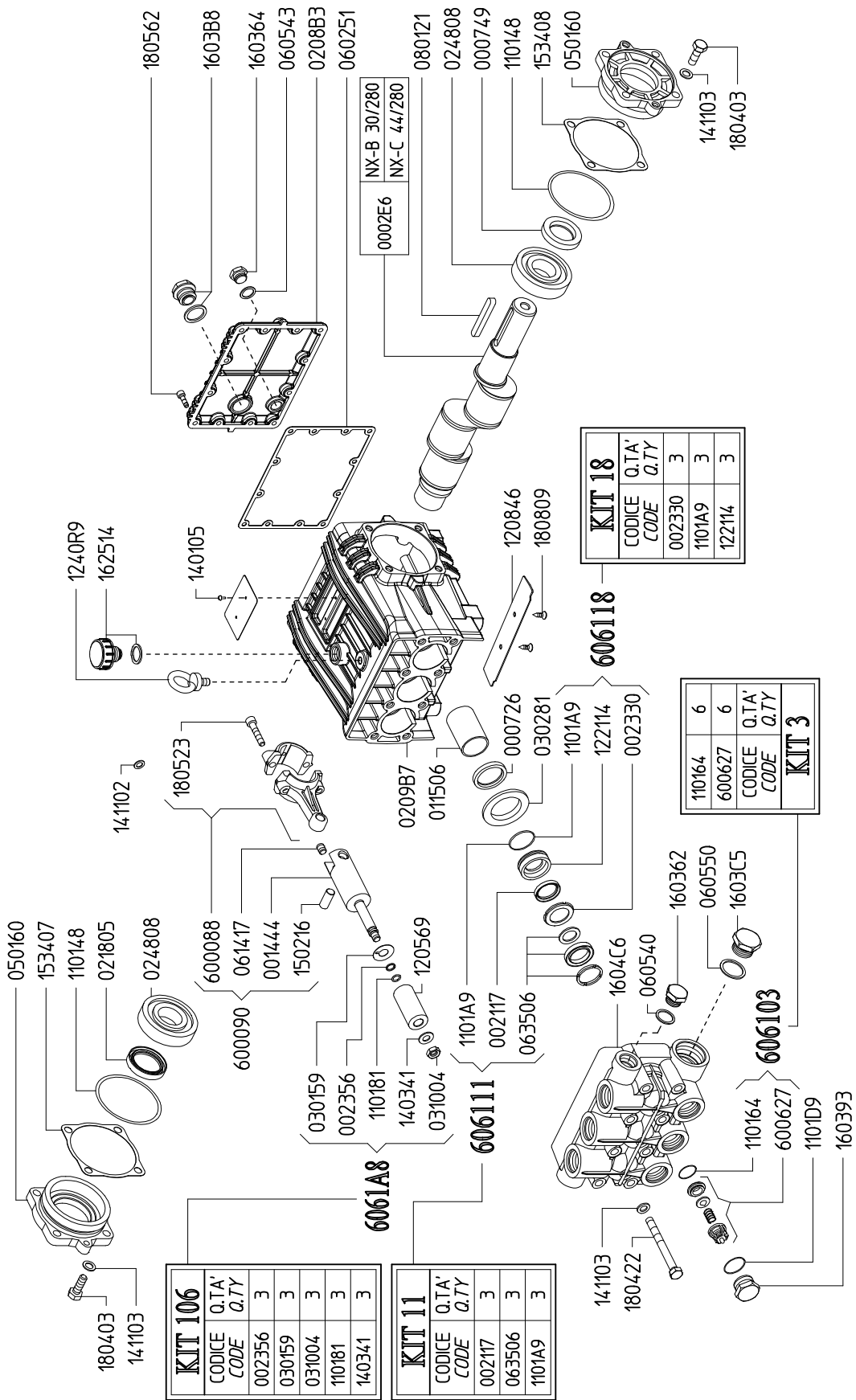

SERIE - SERIES

NX

849200 NX-B 38/200 R

849300 NX-B 38/200 L

849400 NX-B 52/150 R

849500 NX-B 52/150 L

845700 NX-C 55/200 R

846000 NX-C 55/200 L

845800 NX-C 75/150 R

846100 NX-C 75/150 L

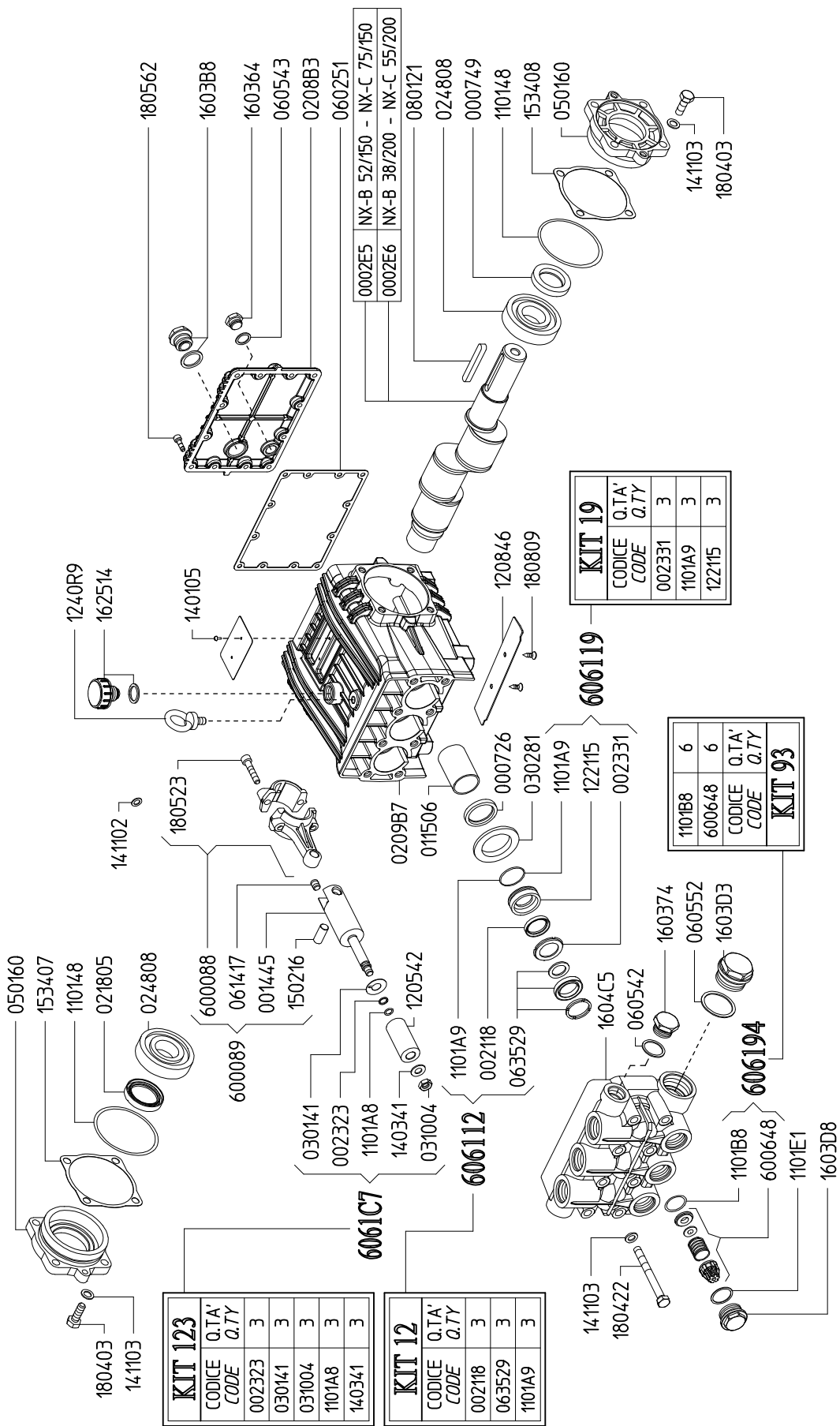

SERIE - SERIES

NX

839800 NX-B 70/120 R

839900 NX-B 70/120 L

839300 NX-C 100/120 R

839400 NX-C 100/120 L

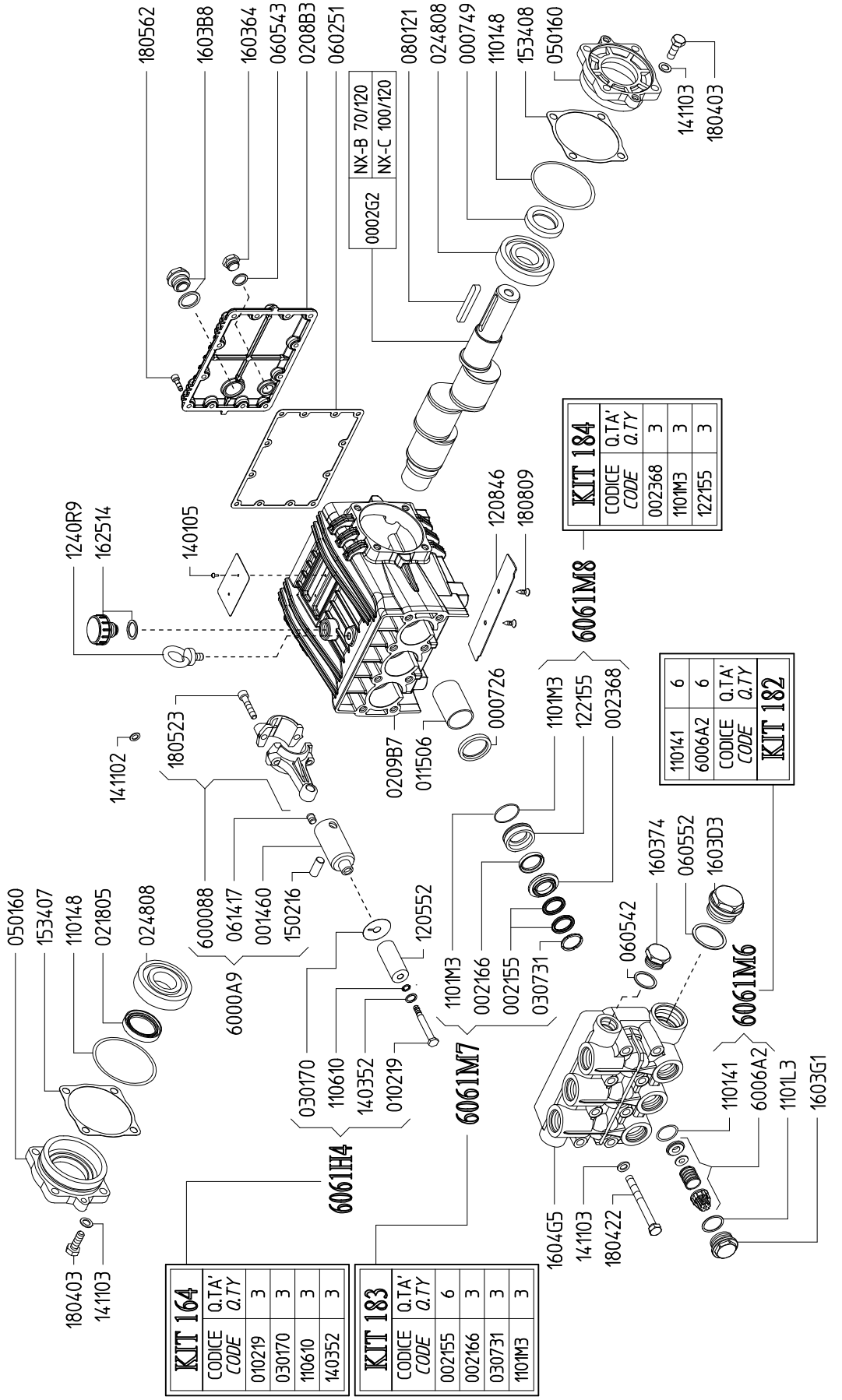

KIT 164		
CODICE CODE	Q.TA'	Q.TY
010219	3	
030170	3	
110610	3	
140352	3	

KIT 183		
CODICE CODE	Q.TA'	Q.TY
002155	6	
002166	3	
030731	3	
1101M3	3	

KIT 184		
CODICE CODE	Q.TA'	Q.TY
002368	3	
1101M3	3	
122155	3	

KIT 182		
CODICE CODE	Q.TA'	Q.TY
110141	6	
6006A2	6	

815300 NX-B 100/100 R

815400 NX-B 100/100 L

803300 NX-C 145/100 R

803400 NX-C 145/100 L

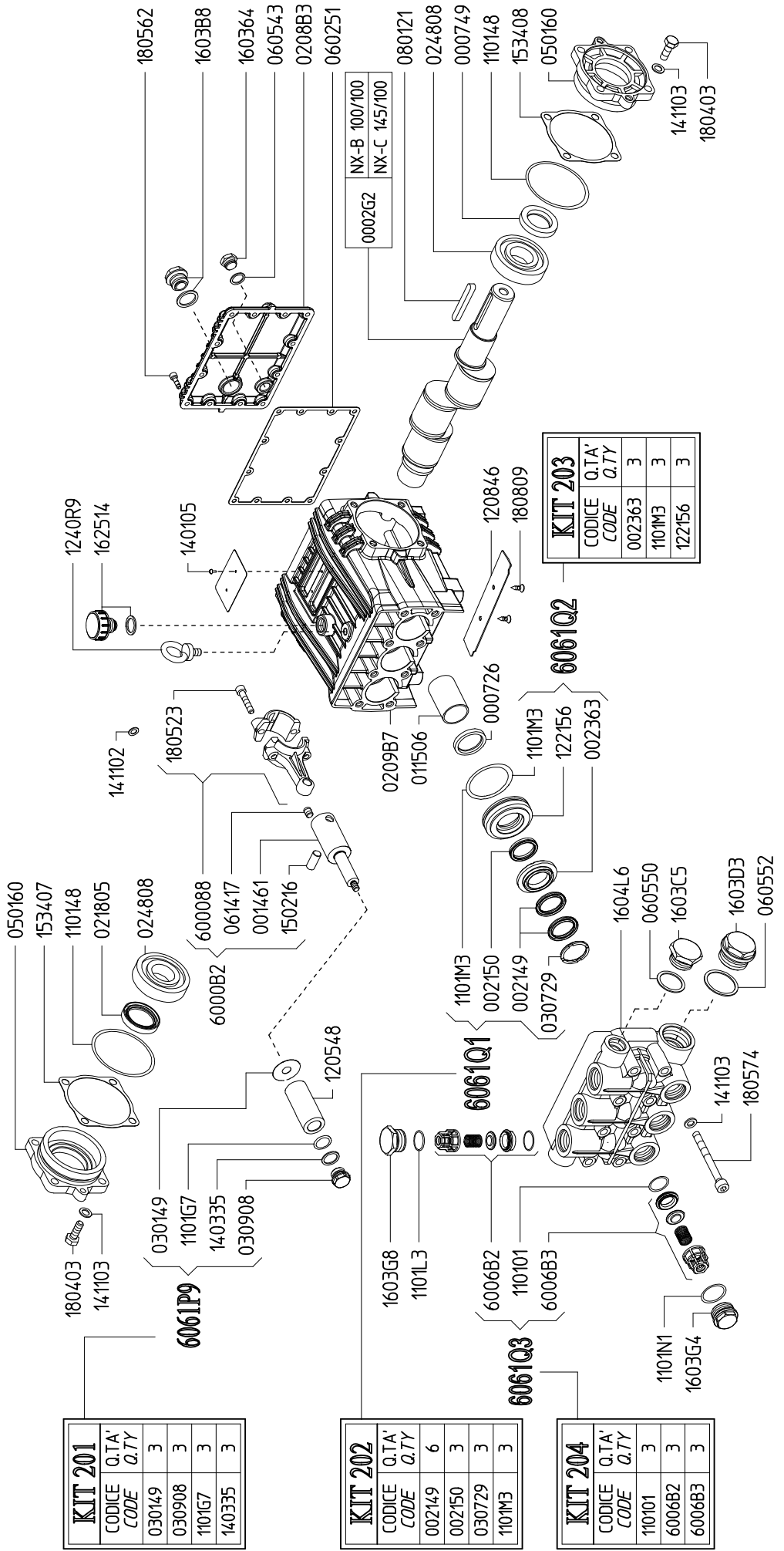

SERIE - SERIES

GAMMA

837700 GAMMA 62 TS 1C

837600 GAMMA 62 TS 2C

837800 GAMMA 62 TS GR

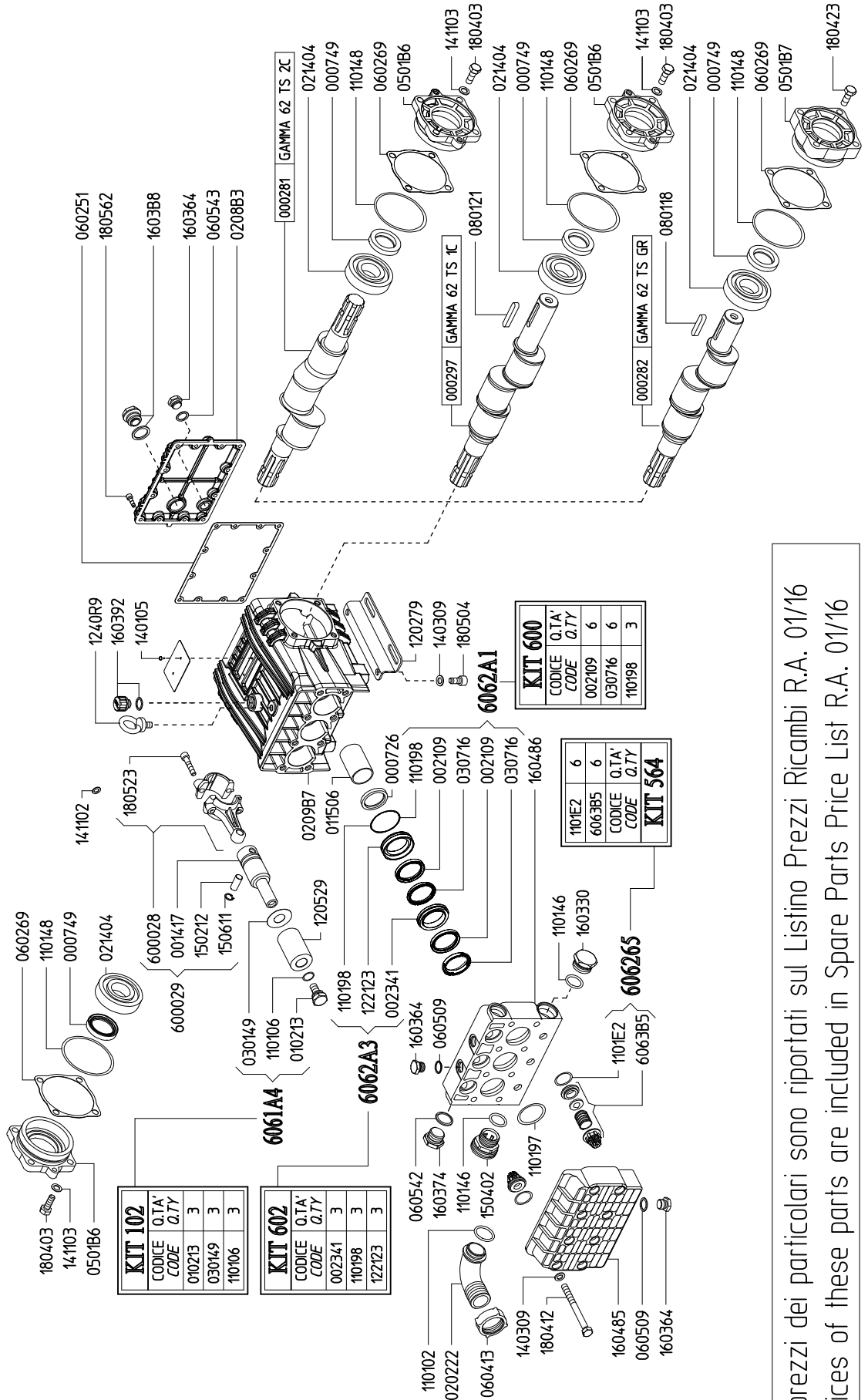

I prezzi dei particolari sono riportati sul Lisino Prezzi Ricambi R.A. 01/16
 Prices of these parts are included in Spare Parts Price List R.A. 01/16

SERIE - SERIES

GAMMA

- 838200 GAMMA 85 TS 1C
- 838700 GAMMA 105 TS 1C
- 839200 GAMMA 125 TS 1C
- 838100 GAMMA 85 TS 2C
- 838600 GAMMA 105 TS 2C
- 839100 GAMMA 125 TS 2C

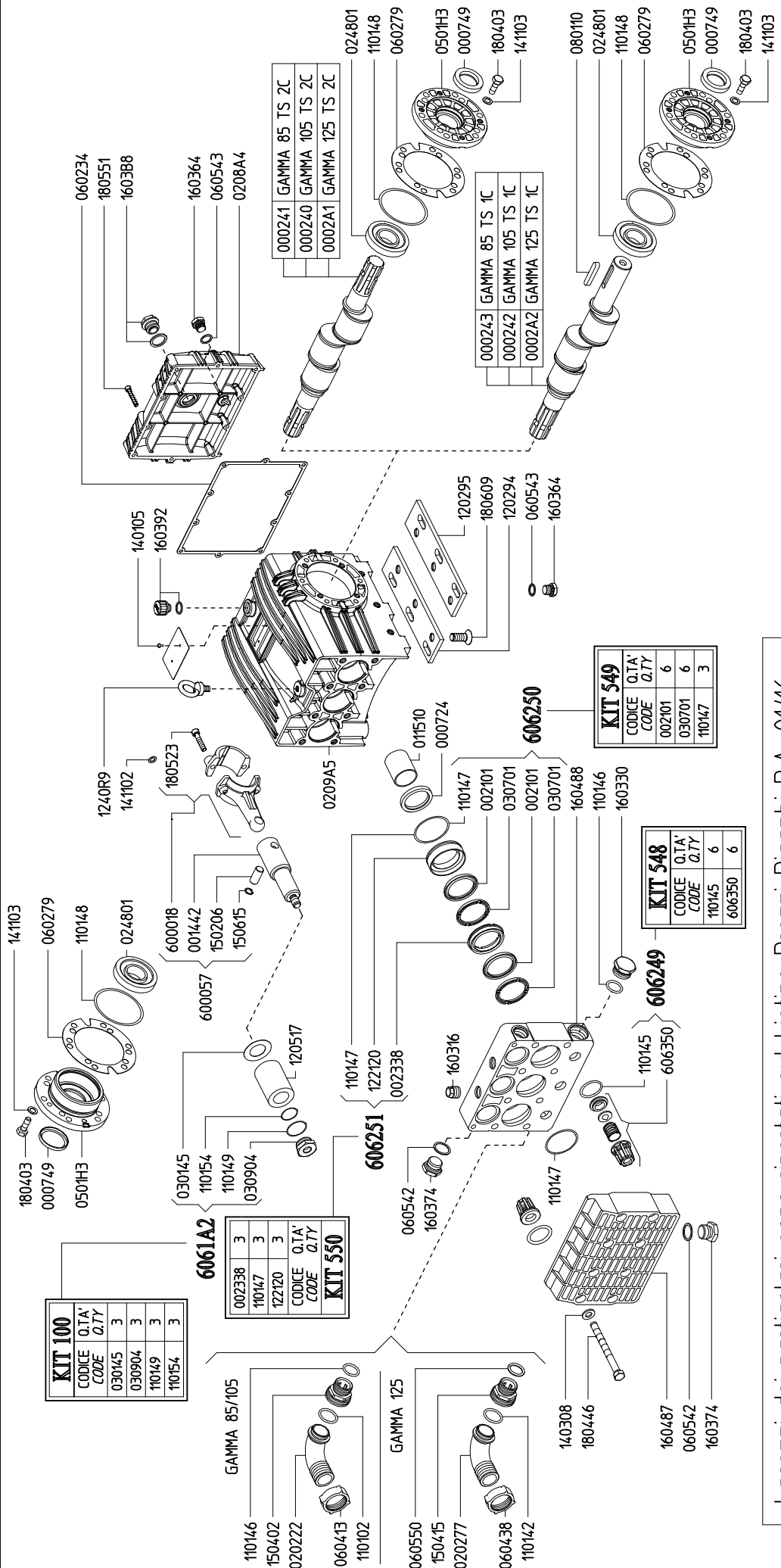

I prezzi dei particolari sono riportati sul Lisino Prezzi Ricambi R.A. 01/16
 Prices of these parts are included in Spare Parts Price List R.A. 01/16

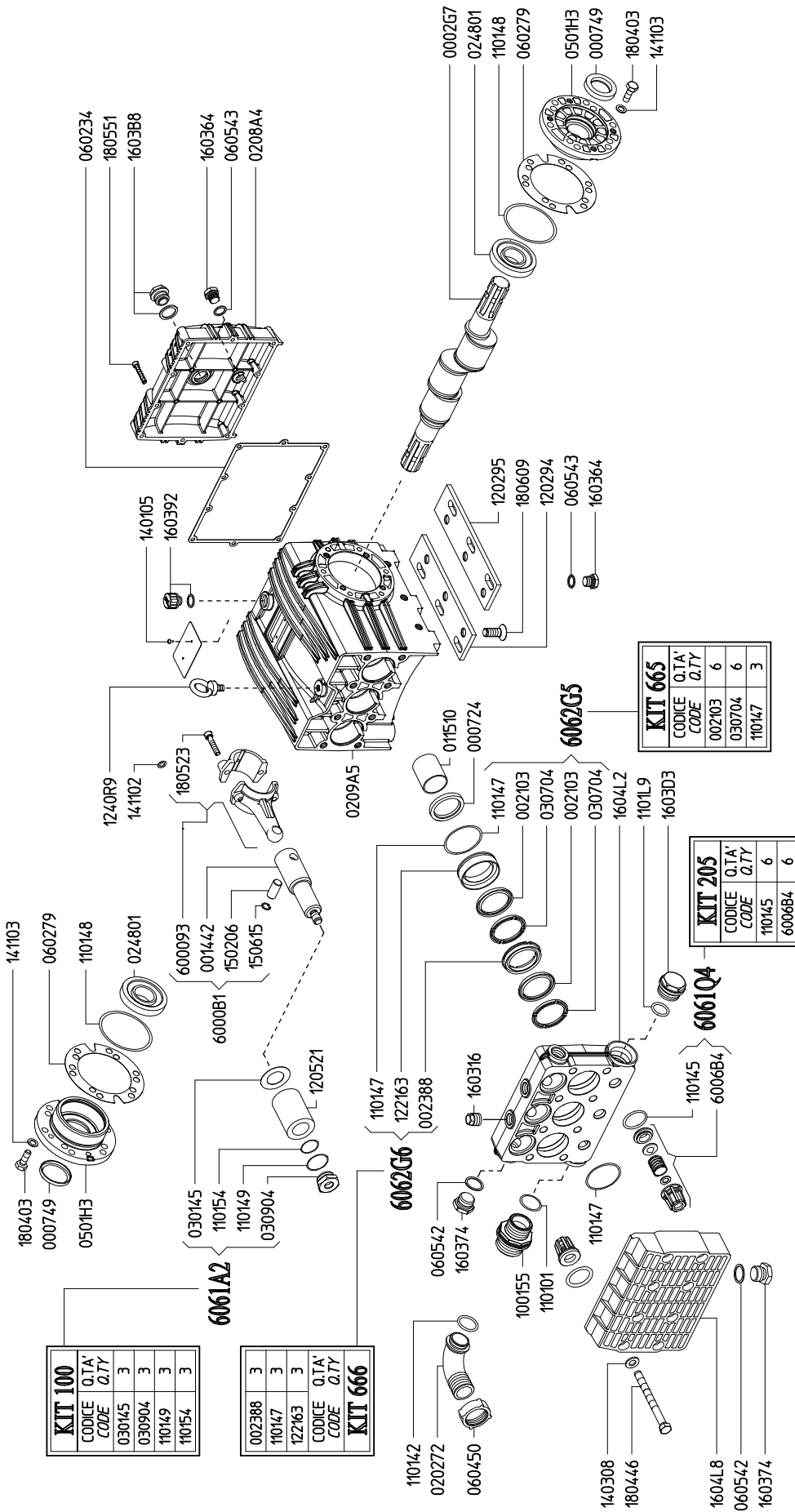

I prezzi dei particolari sono riportati sul Lisino Prezzi Ricambi R.A. 01/16
 Prices of these parts are included in Spare Parts Price List R.A. 01/16

SERIE - SERIES

GAMMA

- 839700 GAMMA 162 TS 1C
- 837200 GAMMA 202 TS 1C
- 840200 GAMMA 242 TS 1C

- 839600 GAMMA 162 TS 2C
- 837100 GAMMA 202 TS 2C
- 840100 GAMMA 242 TS 2C

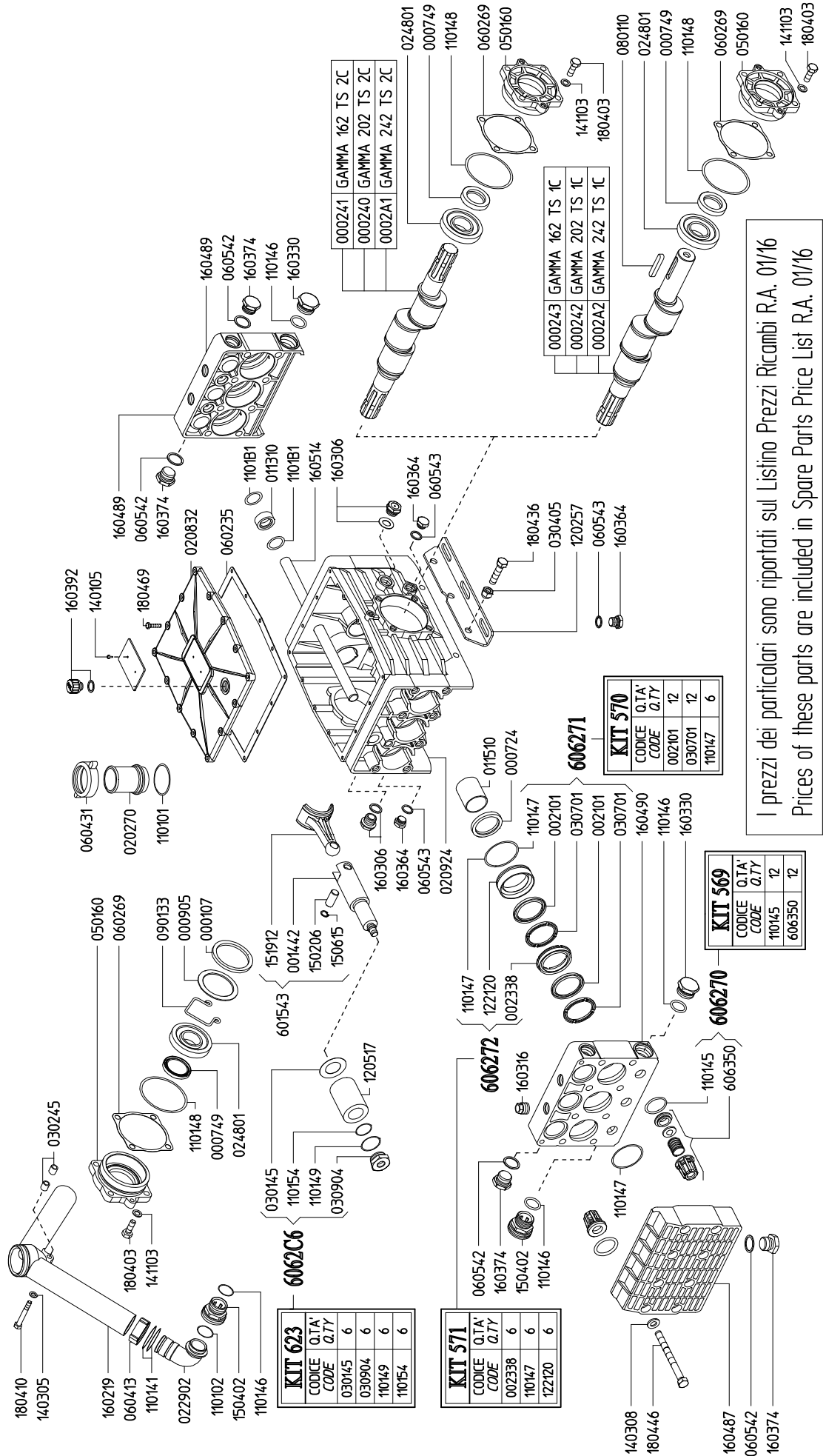

I prezzi dei particolari sono riportati sul Listino Prezzi Ricambi R.A. 01/16
 Prices of these parts are included in Spare Parts Price List R.A. 01/16

SERIE - SERIES

GAMMA-IL

833100 GAMMA-IL 160 TS 1C

833600 GAMMA-IL 200 TS 1C

